

# Distance to the edge matters

## know the zones of a roof

### GENERAL DUTY PROVISIONS 29 CFR 1910.28

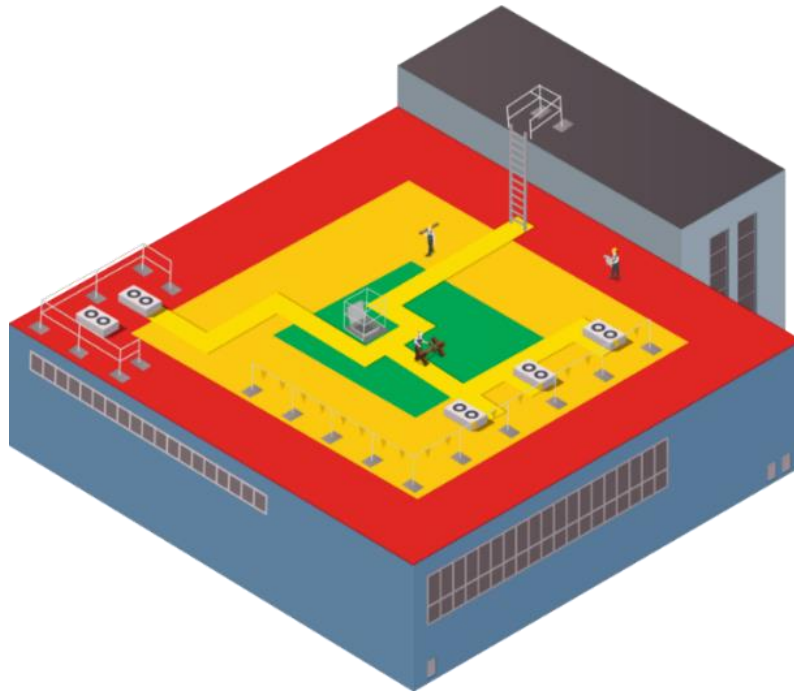

RED ZONE (HIGHEST HAZARD)	DESIGNATED AREA / YELLOW ZONE (MEDIUM HAZARD)	GREEN ZONE (LOWEST HAZARD)
<b>0 to 6 Feet from Edge</b>	<b>6 to 15 Feet from Edge</b>	<b>Greater than 15 Feet from Edge</b>
All workers must wear conventional fall protection	Only for "infrequent and temporary" work, a designated area can be used with a warning line.	Only for "Infrequent and temporary" work
Acceptable fall protection includes: <ul style="list-style-type: none"> <li>• OSHA compliant guardrail system</li> <li>• ANSI compliant personal fall arrest or travel restraint systems</li> </ul>	Warning line sag requirements: <ul style="list-style-type: none"> <li>• Breaking Strength of 200 lbs.</li> <li>• ≥ 34 in. but ≤ 39 in. from walking surface</li> <li>• Visible from 25 ft.</li> <li>• Stamped metal flagging every 6'</li> </ul> A monitoring system combined with a warning line requires: <ul style="list-style-type: none"> <li>• Work monitored by a competent individual to ensure workers are within the designated area</li> </ul>	Not required to provide any fall protection as long as: <ul style="list-style-type: none"> <li>• Employer implements, documents, and enforces a work rule prohibiting employees from going within 15' of edge without using fall protection</li> </ul>
<ul style="list-style-type: none"> <li>• 42-inch-high parapet</li> </ul>		No requirements other than employees must remain at a distance greater than 15' from edge of roof.

Unless

**OSHA Definitions:**

**Temporary:** Tasks that usually take less than 1-2 hours to complete.

**Infrequent:** Tasks performed at intervals (monthly/yearly) or as needed (equipment break down).

**Designated Area:** A space which has a perimeter barrier erected to warn employees when they approach an unprotected side or edge and serves also to designate an area where work may be performed without additional fall protection.